

Personalizing Comfort

07/06/2012

Standard

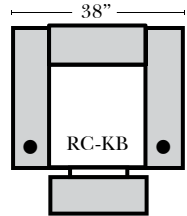

2 Arm Recliner-152

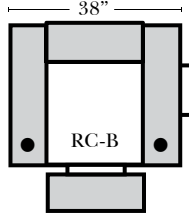

Left Arm Right
Straight Arm
Center Recliner-151

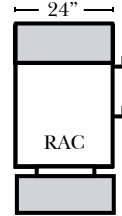

Armless
Recliner-153

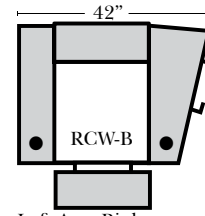

Left Arm Right
Wedge Arm
Recliner-159

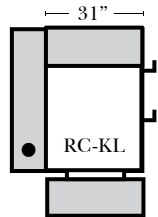

Left Arm End
Recliner-155

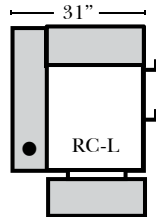

Left Straight
Arm Center
Recliner-157

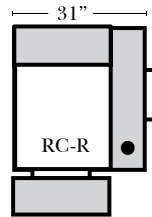

Right Straight
Arm Center
Recliner-156

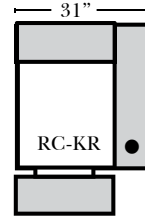

Right Arm End
Recliner-154

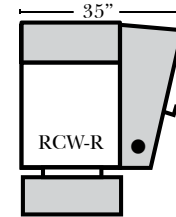

Right Wedge Arm
Center Recliner-158

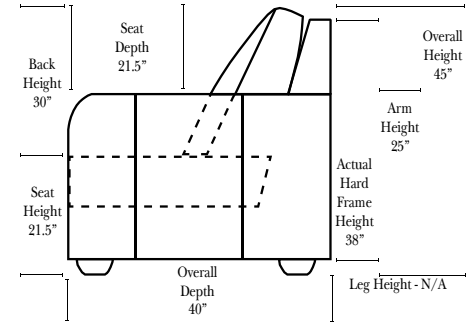

Features

Standard:

- Available in Full & Top Grain Leathers
- Available in Luxury Fabrics
- All Hardwood Frames
- Standard Cup Holders in Silver Finish - Optional colors are Black and Hammered Antique

Options:

- No. 33 Firm Foam (N/C Option)
- Wood Table W/Swivel: Standard finish - Espresso
Optional finish - Honey Oak (Additional Charge)
- Motorized Recliner Mechanism (zero wall only)
(Additional Charge)

Sleeper Options: (No Sleepers available on this style)

Note:

All Dimensions are approximate, if accuracy is crucial, please contact us for validation of the dimensions shown. However, a 1" to 2" variance can still apply due to foam and upholstery.

Suggested Configurations

